

462m² Office for Rent in Limassol - Neapolis

Position your business at the forefront of innovation in one of Limassol’s most advanced commercial towers. The 12th floor offers a net office space of 285 m², complemented by an additional 177 m² of finished common areas, including a modern lobby, high-spec restrooms, and dedicated storage space—all located on the same floor for maximum convenience.



Designed for today’s businesses, the tower redefines the workplace experience with 12,600 m² of flexible office space, an executive business centre, and fully equipped meeting facilities. Tenants benefit from premium amenities, including landscaped green areas, a gym, and dedicated social hubs that foster wellness and pr...

Property Info		Plot / Area Info		Additional info	
Covered Area	462	Parking	Covered, Yes	Reference Number	7914
Floor Number	12			Property type	Office
Total Number of Floors	25			Condition	Under Construction
Amenities	Location				
• Parking	Location: Limassol - Neapolis			Region: Limassol	
	Coordinates: 34.687419127325 / 33.050715857427				

## Price: €21 500 + VAT

VAT for this property is **€3,108** or **€4,085**. VAT usually is 19%. If it is your first purchase of property, you can have VAT reduced to 5% for the first 150sq.m. of the property.

VAT	<b>Excluded</b>	Title transfer fee	<b>None</b>	Common expenses	<b>None</b>
		Price per SQM	<b>€47.00/m<sup>2</sup></b>		

## Representative: RealDeal Estates

Registration number	<b>1311</b>	Email	<b>info@realdeal.cy</b>
License number	<b>347/E</b>	Legal name	<b>Esperia Estates (Limassol-Paphos) Limited</b>
Phone: <b>+35725255505, +35794001333</b>			

## Price change history



€21 500 on Jul 22, 2025

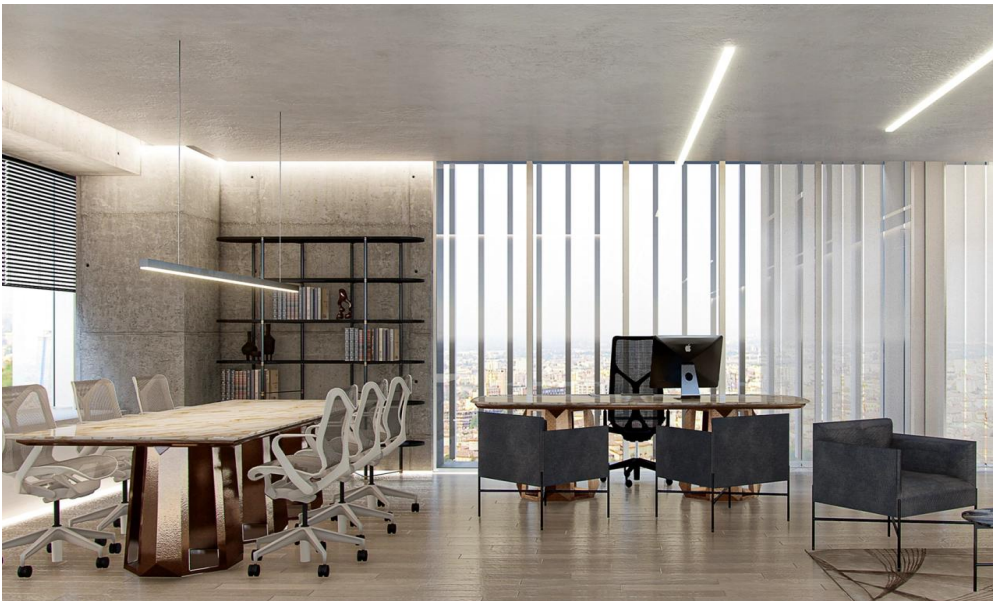





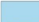

12th OFFICE FL. PLAN		
OFFICE- NET AREA		285 sq.m.
COMMONS AREA		177 sq.m.
GROSS AREA	= 462 sq.m.	