

3 Bedroom Apartment for Sale in Limassol - Marina

This Limassol luxury apartment is one of the most prestigious listings in Cyprus luxury real estate, offering a unique combination of lifestyle appeal and investment security. Positioned on the 26th floor of a landmark Limassol tower, this beachfront and seafront apartment next to Limassol Marina delivers uninterrupted panoramic views of the Mediterranean Sea, full privacy, and access to 7-star lifestyle amenities that set a new benchmark for Limassol luxury properties. 

With a total covered area of 267.70 sqm — including 143 sqm of internal living space, 42 sqm of covered veranda, and 82.70 sqm of common areas — this apartment blends modern elegance with functional design. A pr...

Property Info

Covered Area	270.8
Furnishing	Unfurnished
Heating	Underfloor Heating, Yes
Air Conditioning	All rooms, Yes

Plot / Area Info

Plot area	1701
Pool	Yes
Parking	Covered, Yes

Additional info

Reference Number	31349
Property type	Apartment
Condition	Brand New
Bathrooms	3
View	Sea view

Amenities

- Gym

Location

Location: Limassol - Marina
Coordinates: **34.669254807674 / 33.035301515604**
 Region: **Limassol**

Price: €2 445 000 + VAT

VAT for this property is **€274,383** or **€464,550**. VAT usually is 19%. If it is your first purchase of property, you can have VAT reduced to 5% for the first 150sq.m. of the property.

VAT	Excluded	Title transfer fee	None	Common expenses	None
		Price per SQM	€9 056.00/m²		

Representative: FOX

Registration number	488	Email	info@foxrealty.com.cy
License number	344/E	Legal name	FOX Smart Estate Agency Network Ltd
Phone: +35726940150, +35725267777, +35725760781			

Price change history

€150 000 on Mar 1, 2024
 €2 240 000 on Oct 4, 2025
 €2 245 000 on Nov 18, 2025
 €2 445 000 on Feb 5, 2026









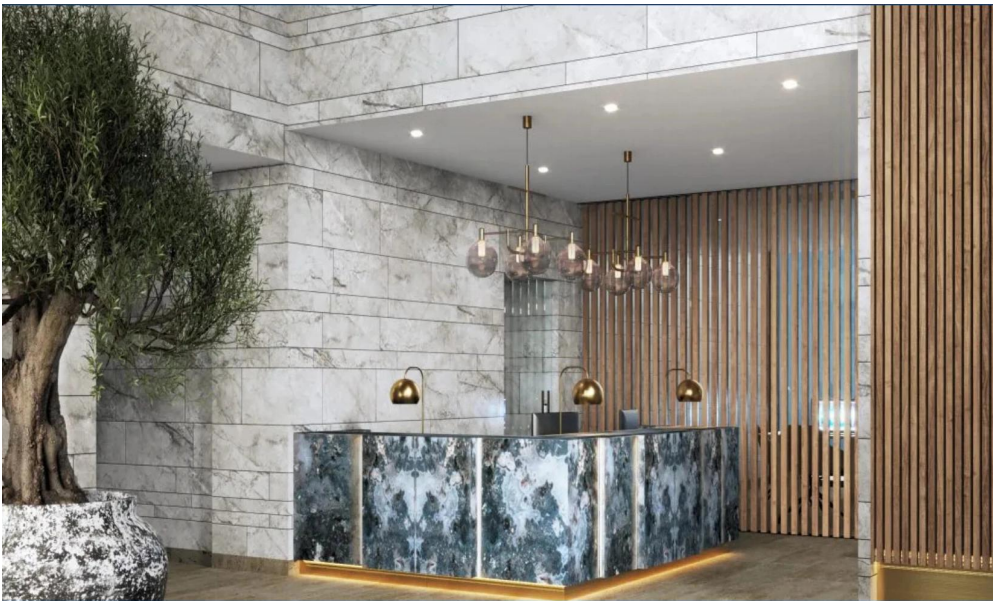





PRELIMINARY Master Plan.

- 1 Poseidon Tower
- 2 Cavalli Tower - At Limassol Blu Marine
- 3 Oceanus Tower
- 4 Office Tower
- 5 Main Entrance and Guard House
- 6 Outdoor Swimming Pool
- 7 Residents' Lounge
- 8 Spa and Indoor Swimming Pool
- 9 Public Car Park Entrance
- 10 Green Area
- 11 Children's Playground
- 12 Fountain Pond
- 13 Gymnasium
- 14 Observation Point
- 15 Restaurant
- 16 Bistro
- 17 Drop-off Point
- 18 Podium Level
- 19 Communal Area