

## 3 Bedroom Apartment for Sale in Limassol District

Luxury apartment for sale, located on the seashore in the area of Tsiflikoudia, Limassol. The project is located in the heart of Limassol and consists of 3 residential towers offering unobstructed views of the Mediterranean Sea from all residences and verandas, as well as 4,300 square meters of outdoor living amenities. In addition, the project is a great investment opportunity due to its ideal location—just 300 meters from the Limassol Marina. The complex will have a 50-meter outdoor pool with panoramic sea views, a 25-meter indoor heated pool with natural light, 13,000 square meters of SPA area and fitness room. Underground parking, a bistro and a restaurant, as well as round-the-cloc...

### Property Info

Covered Area	<b>272</b>
Furnishing	<b>Unfurnished</b>
Energy Efficiency	<b>A</b>
Air Conditioning	<b>No</b>

### Plot / Area Info

Parking	<b>Covered, Yes</b>
---------	---------------------

### Additional info

Reference Number	<b>98140</b>
Property type	<b>Apartment</b>
Condition	<b>Brand New</b>
Bathrooms	<b>3</b>

### Amenities

### Location

Region: **Limassol**

## Price: €3 682 000 + VAT

VAT for this property is **€415,308** or **€699,580**. VAT usually is 19%. If it is your first purchase of property, you can have VAT reduced to 5% for the first 150sq.m. of the property.

VAT	<b>Excluded</b>	Title transfer fee	<b>None</b>	Common expenses	<b>None</b>
		Price per SQM	<b>€13 537.00/m<sup>2</sup></b>		

## Representative: DOM Real Estate

Registration number	<b>397</b>	Email	<b>info@dom.com.cy</b>
License number	<b>338/E</b>	Legal name	<b>N/A</b>
Phone: +35796644888			

## Price change history

€3 682 000 on May 9, 2024





Preliminary Floor Plan

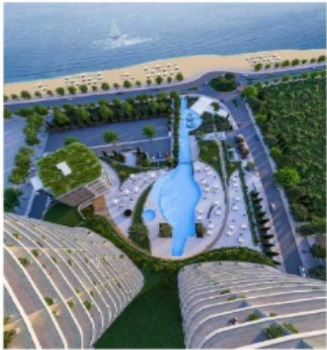

## Apartment 3202 / 3 Bedrooms Poseidon Tower

Preliminary Apartment Plan

