

## 3 Bedroom Apartment for Sale in Limassol District

- 3 bedrooms
- 3 W/C
- Internal Area 121m<sup>2</sup>
- Covered Verandas 25m<sup>2</sup>
- Uncovered Verandas 17m<sup>2</sup>
- Garden 95m<sup>2</sup>
- Covered Parking
- Communal Swimming Pool
- Panoramic View
- Close to the beach



### Property Info

Covered Area  
Heating  
Air Conditioning

**121**  
**Central Heating, Yes**  
**All rooms, Yes**

### Plot / Area Info

Pool  
Parking

**Yes**  
**Covered, Yes**

### Additional info

Reference Number  
Property type  
Condition  
Bathrooms

**6598**  
**Apartment**  
**Brand New**  
**3**

### Amenities

- Guest WC

### Location

Region: **Limassol**  
Coordinates: **34.7227518 / 33.0845277**

## Price: €725 000 + VAT

VAT for this property is **€36,250** or **€137,750**. VAT usually is 19%. If it is your first purchase of property, you can have VAT reduced to 5% for the first 150sq.m. of the property.

|     |                 |                    |                                |                 |             |
|-----|-----------------|--------------------|--------------------------------|-----------------|-------------|
| VAT | <b>Excluded</b> | Title transfer fee | <b>None</b>                    | Common expenses | <b>None</b> |
|     |                 | Price per SQM      | <b>€5 992.00/m<sup>2</sup></b> |                 |             |

## Representative: Kadis Estates

|                            |             |            |                          |
|----------------------------|-------------|------------|--------------------------|
| Registration number        | <b>506</b>  | Email      | <b>info@kadis.com.cy</b> |
| License number             | <b>62/E</b> | Legal name | <b>N/A</b>               |
| Phone: <b>+35722344842</b> |             |            |                          |

## Price change history

€710 000 on Jul 12, 2024  
 €725 000 on Mar 13, 2025

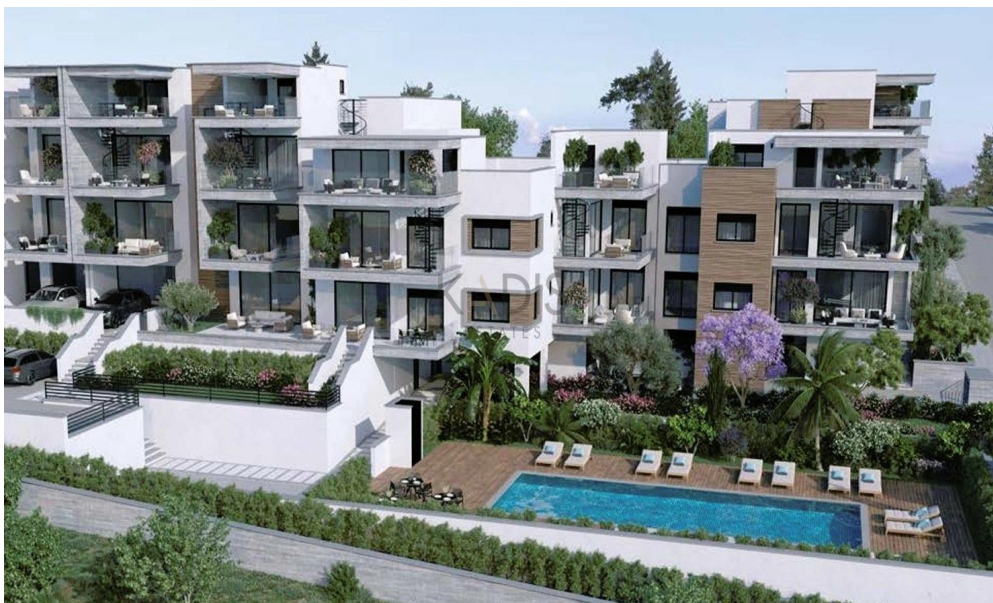



## LEVEL 2

1. Block A | Entrance
2. Block B | Entrance
3. Block C | Entrance
4. Block D | Entrance
5. Storage
6. Lift
7. Garden
8. Private Garden
9. Vehicle Entry / Exit
10. Parking Area
11. Garbage
12. Pavement



## LEVEL 3

1. Block A | Entrance
2. Block B | Entrance
3. Block C | Entrance
4. Block D | Entrance
5. Storage
6. Lift
7. Garden
8. Private Garden
9. Vehicle Entry / Exit
10. Pavement



## LEVEL 4

1. Block A | Entrance
2. Block B | Entrance
3. Block C | Entrance
4. Block D | Entrance
5. Storage
6. Lift



## LEVEL 5

1. Block A | Entrance
2. Roof Garden A201
3. Roof Garden A202
4. Roof Garden A203
5. Block B | Entrance
6. Roof Garden B201
7. Roof Garden B202
8. Block D | Entrance
9. Roof Garden D302
10. Roof Garden / Storage

