

## 3 Bedroom House for Sale in Pegeia, Paphos District

3 Bedroom Villa – Contemporary Coastal Elegance with Panoramic Sea Views ✖

### Intro

This 3-bedroom villa offers a refined coastal lifestyle, combining contemporary design with expansive indoor-outdoor living. Positioned in the heart of Peyia’s most exclusive coastal area, the villa enjoys direct views of the Mediterranean Sea and the dramatic natural landscapes surrounding Coral Bay and Akamas.

### Design & Architecture

With its sleek architectural form, extensive glass surfaces, and balanced geometric shapes, the villa is designed to maximise light, openness, and scenic outlooks. Its façade blends modern sophistication with natural textures, creating a timeless ...

### Property Info

Covered Area	<b>236</b>
Covered Veranda	<b>27</b>
Uncovered Veranda	<b>163</b>
Energy Efficiency	<b>A</b>

### Plot / Area Info

Plot area	<b>890</b>
Pool	<b>Yes</b>

### Additional info

Reference Number	<b>231874</b>
Property type	<b>House</b>
Condition	<b>Under Construction</b>
Construction Year	<b>2026</b>
Bathrooms	<b>2</b>

### Amenities

### Location

**Location:** Pegeia

Coordinates: **34.880525660044974 / 32.36123275513882**

Region: **Paphos**

## Price: €827 000 + VAT

VAT for this property is **€83,541** or **€157,130**. VAT usually is 19%. If it is your first purchase of property, you can have VAT reduced to 5% for the first 150sq.m. of the property.

VAT	<b>Excluded</b>	Title transfer fee	<b>None</b>	Common expenses	<b>None</b>
		Price per SQM	<b>€3 504.00/m<sup>2</sup></b>		

## Representative: MySpace

Registration number	<b>229/E</b>	Email	<b>myspace.cyprus@gmail.com</b>
License number	<b>1047</b>	Legal name	<b>MYSPLACE Real Estate/ A.SP.Thinkrealty ltd</b>
Phone:	<b>+35795129336, +35799409010</b>		

## Price change history

€827 000 on Sep 10, 2024

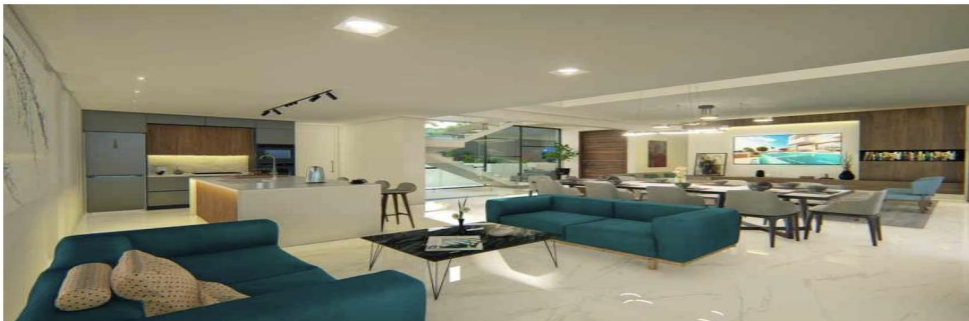

VILLA TYPE 2A AND 2A\*  
3 & 4 BEDROOMS

PLOT No.	VILLA TYPE	PLOT AREA (m <sup>2</sup> )	BEDROOMS	COV. AREA (m <sup>2</sup> )	COV. VERANDA (m <sup>2</sup> )	TOTAL COV. AREA (m <sup>2</sup> )	CARPORT (m <sup>2</sup> )	UNCOV. VERANDA (m <sup>2</sup> )
1262	2 A	948,00	3	180,30	55,90	236,20	19,40 (COV.)	138,80