

## 2 Bedroom House for Sale in Mandria, Paphos District

This is a modern 2-bedroom semi-detached house surrounded by beautiful landscapes in the village of Mandria in the district of Paphos. The house enjoys spacious outdoor areas and covered verandas in a tranquil setting, perfect for raising a family and spending relaxing summer vacations. It is within walking distance to known sandy beaches and other amenities such as bars and local taverns. 

This is an exceptional property development that combines both traditional Mediterranean and Modern 3 and 4 bedroom villas along with 2 and 3 bedroom semi detached houses for sale. The properties are surrounded by beautiful landscapes in the village of Mandria in the district of Paphos. All res...

### Property Info

Covered Area	<b>134</b>
Covered Veranda	<b>25</b>
Uncovered Veranda	<b>8</b>
Total Number of Floors	<b>2</b>
Energy Efficiency	<b>A</b>

### Plot / Area Info

Plot area	<b>180</b>
Pool	<b>Common, Yes</b>
Parking	<b>Uncovered, Yes</b>

### Additional info

Reference Number	<b>1508</b>
Property type	<b>House</b>
Bathrooms	<b>2</b>

### Amenities

- Roof Garden

### Location

**Location:** Mandria

Region: **Paphos**

Coordinates: **34.709841587006 / 32.529884569409**

## Price: €335 000 + VAT

VAT for this property is **€16,750** or **€63,650**. VAT usually is 19%. If it is your first purchase of property, you can have VAT reduced to 5% for the first 150sq.m. of the property.

VAT	<b>Excluded</b>	Title transfer fee	<b>~€10 000.00</b>	Common expenses	<b>None</b>
		Price per SQM	<b>€2 500.00/m²</b>		

## Representative: RealDeal Estates

Registration number	<b>1311</b>	Email	<b>info@realdeal.cy</b>
License number	<b>347/E</b>	Legal name	<b>Esperia Estates (Limassol-Paphos) Limited</b>
Phone: <b>+35725255505, +35794001333</b>			

## Price change history

€335 000 on Apr 8, 2025





MASTER PLAN

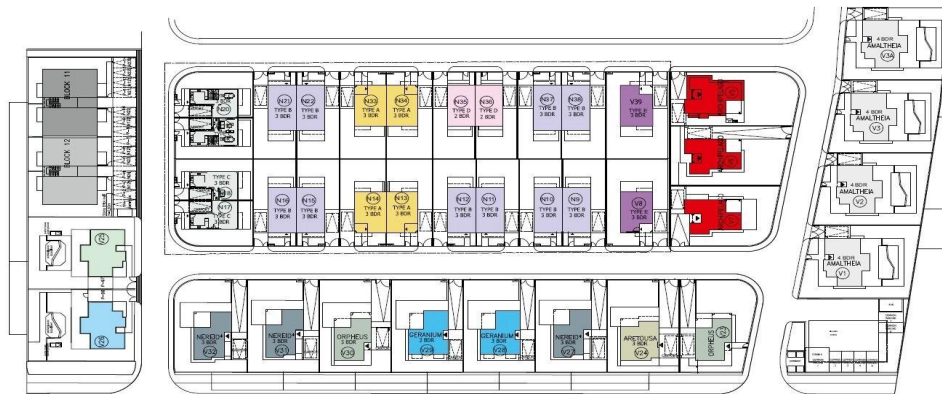

MASTER PLAN

