

2 Bedroom Apartment for Sale in Limassol - Agios Athanasios

Experience coastal lifestyle at its finest, just moments from the sea.



Boutique living with a nautical spirit, blending quality, convenience and wellbeing, in a prime location.

- Only 50m from the sea, near Limassol's Nautical Club.
- 37 spacious, well-designed two and three-bedroom apartments.
- Penthouses with private roof terraces.
- Communal swimming pool and landscaped gardens.
- One-minute walk to the beach, easy access to the city centre and the highway.
- Surrounded by an array of amenities, services and facilities, including hotels, cafés, restaurants, supermarkets and more.

Property Info

Plot / Area Info

Additional info

Covered Area	109				
Covered Veranda	19				
Floor Number	5	Pool	Common, Yes	Reference Number	4499
Total Number of Floors	5	Parking	Covered, Yes	Property type	Apartment
Energy Efficiency	A				
Heating	Underfloor Heating, Yes				

Amenities

- Roof Garden

Location

Location: Limassol - Agios Athanasios

Region: **Limassol**

Coordinates: **34.691009599201 / 33.072881679785**

Price: €850 000 + VAT

VAT for this property is **€42,500** or **€161,500**. VAT usually is 19%. If it is your first purchase of property, you can have VAT reduced to 5% for the first 150sq.m. of the property.

VAT	Excluded	Title transfer fee	~€30 600.00	Common expenses	None
		Price per SQM	€7 798.00/m²		

Representative: RealDeal Estates

Registration number	1311	Email	info@realdeal.cy
License number	347/E	Legal name	Esperia Estates (Limassol-Paphos) Limited
Phone: +35725255505, +35794001333			

Price change history

€850 000 on May 7, 2025



GROUND FLOOR

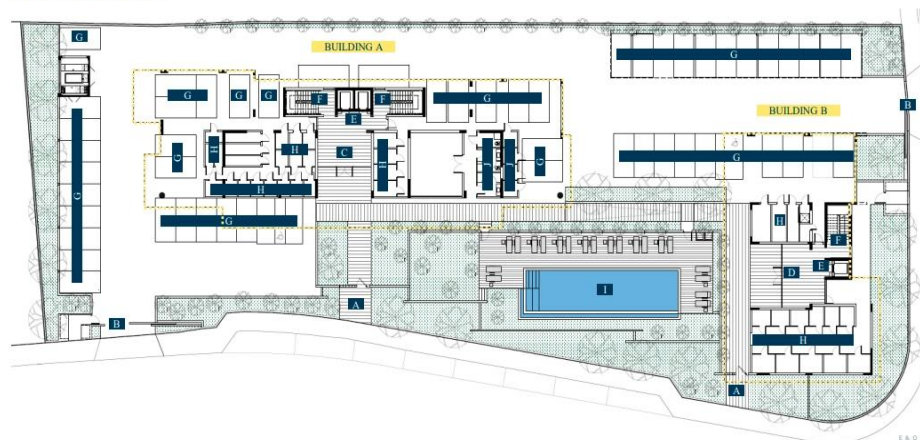

- | | | | | |
|---------------------------|----------------------------|-------------|-----------------|--------------------------|
| A Pedestrian entrance | C Building A main entrance | E Lift | G Parking space | I Swimming pool |
| B Parking entrance / exit | D Building B main entrance | F Staircase | H Storeroom | J Changing room & toilet |

BUILDING A ROOF TERRACES

