

3 Bedroom House for Sale in Parekkklisia, Limassol District

THE PROJECT Discover a serene lifestyle in Limassol s charming Parekkklisia area with our upcoming community of 22 plots and houses. Nestled amidst the picturesque surroundings this project seamlessly combines modern convenience with tranquillity. Enjoy easy access to various amenities while relishing the peaceful ambiance. Each thoughtfully designed residence embodies comfort and functionality. Location Situated in Parekkklisia Limassol this residential complex has as a primary aim to provide homeowners with a unique opportunity to seamlessly blend a serene countryside family oriented lifestyle with the energetic vibrancy of modern city living. Residents can enjoy the tranquillity of the a...

Property Info

| | |
|------------------------|------------|
| Covered Area | 148 |
| Total Number of Floors | 2 |
| Energy Efficiency | A |

Plot / Area Info

Plot area **430**

Additional info

| | |
|------------------|----------------|
| Reference Number | VL47805 |
| Property type | House |
| Bathrooms | 3 |

Amenities

- Balcony

Location

Location: Parekkklisia Region: **Limassol**

Price: €480 000 + VAT

VAT for this property is **€24,000** or **€91,200**. VAT usually is 19%. If it is your first purchase of property, you can have VAT reduced to 5% for the first 150sq.m. of the property.

| | | | | | |
|-----|-----------------|--------------------|--------------------------------|-----------------|-------------|
| VAT | Excluded | Title transfer fee | ~€15 800.00 | Common expenses | None |
| | | Price per SQM | €3 243.00/m² | | |

Representative: Nicolaou Estates

| | | | |
|---------------------|--------------|------------|--------------------------------------|
| Registration number | 693 | Email | pnicolaou@nicolaouestates.com |
| License number | 365/E | Legal name | Nicolaou Estates LTD |
| Phone: | | | |

Price change history

€480 000 on May 27, 2025



the land

| PLOTS | |
|------------------|------------------------|
| Plots | 22 |
| Size | from 430m ² |
| Building Density | 30% |
| Floors | 2 |
| € 135.000 + VAT | |

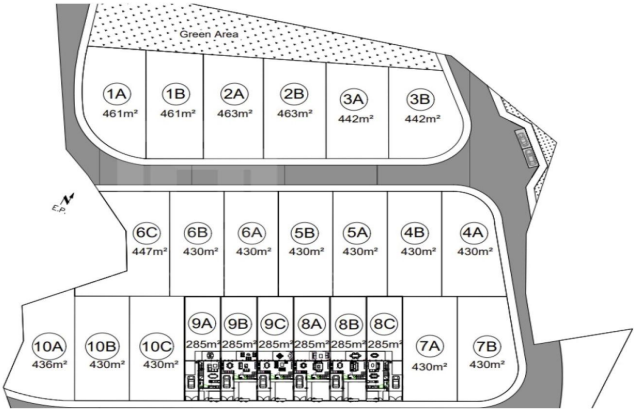

| Eastern Pearl 3 House | |
|-----------------------|-------------------------|
| Plot Size | 430 - 463m ² |
| Internal | 148m ² |
| Covered Veranda | 18m ² |
| Uncovered Veranda | 18m ² |
| €480.000 + VAT | |

*prices are subject to change without prior notice

