

2 Bedroom House for Sale in Pissouri, Limassol District

Two Bedroom Detached Bungalow For Sale In Pissouri, Limassol - Title Deeds (New Build Process) Ideally nestled on the highest hilltop of Pissouri village overlooking Pissouri Bay, one of the best beaches on the island. Just off the main Paphos to Limassol road, next to Pissouri National Century Park - National treasure of Cyprus. A selection of 38 contemporary homes comprises of 25 two and three bedroom villas together with 13 two and three bedroom bungalows. All units have open plan living, dining & kitchen areas with private swimming pool surrounded with extensive outdoor patio & gardens. - 2 Bedrooms with fitted wardrobes - Open pla...



Property Info

Covered Area

90

Plot / Area Info

Pool

Yes

Additional info

Reference Number

pga036n2

Property type

House

Condition

Brand New

Bathrooms

2

Amenities

Location

Location: Pissouri

Region: **Limassol**

Coordinates: **34.65849 / 32.69406**

Price: €449 000 + VAT

VAT for this property is **€22,450** or **€85,310**. VAT usually is 19%. If it is your first purchase of property, you can have VAT reduced to 5% for the first 150sq.m. of the property.

VAT	Excluded	Title transfer fee	None	Common expenses	None
		Price per SQM	€4 989.00/m²		

Representative: Emerald Property Consultants

Registration number	845	Email	info@cyprusemerald.com
License number	329/E	Legal name	N/A
Phone: +35723080080			

Price change history

€418 000 on Oct 20, 2023

€449 000 on Sep 2, 2024

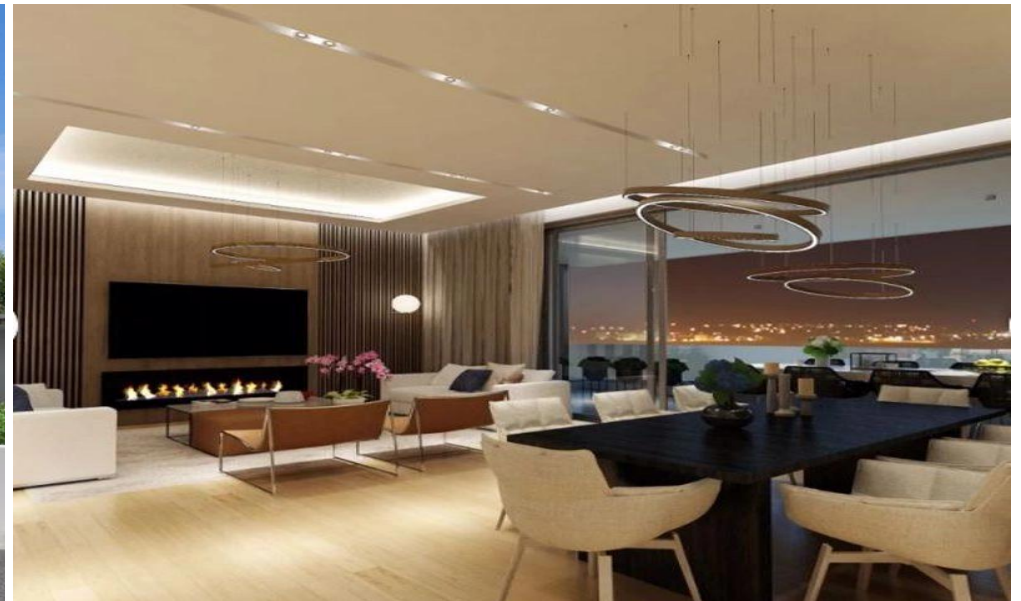

VILLA TYPE D2



Houses	3, 4, 12
Bedrooms	2
Bathrooms	2
Uncovered veranda, SQM	12
Total covered area, SQM	111

