

32,177m² Plot for Sale in Palodeia, Limassol District

For sale: Development Land in Palodeia, offering a unique opportunity for investors and developers. This large plot measures 32,177 square meters and is ideal for a wide range of projects, whether residential or commercial.



Palodeia is a peaceful area known for its blend of natural beauty and convenient access to city amenities. The community combines a relaxed atmosphere with the advantage of being close to city life, making it a popular choice for families and those seeking a quiet environment. Palodeia is surrounded by greenery, offering walking trails and fresh air, while remaining just a short drive from shopping centers, schools, and other daily essentials.

The plot it...

Property Info		Plot / Area Info		Additional info	
				Reference Number	27817
		Plot area	32177	Property type	Land and Plots
				View	City view
Amenities		Location			
		Location: Palodeia		Region: Limassol	
		Coordinates: 34.735700504916 / 33.012189866979			

**Price: €2 750 000 + VAT**

VAT	<b>Excluded</b>	Title transfer fee	<b>~€106 600.00</b>	Common expenses	<b>None</b>
		Price per SQM	<b>€85.00/m<sup>2</sup></b>		

## Representative: Kazo Real Estate

Registration number	<b>694</b>	Email	<b>info@kazo.com.cy</b>
License number	<b>372/E</b>	Legal name	<b>N/A</b>
Phone: <b>+35770003020, +35725346402</b>			

## Price change history

€2 500 000 on Sep 12, 2025

€2 750 000 on Oct 7, 2025

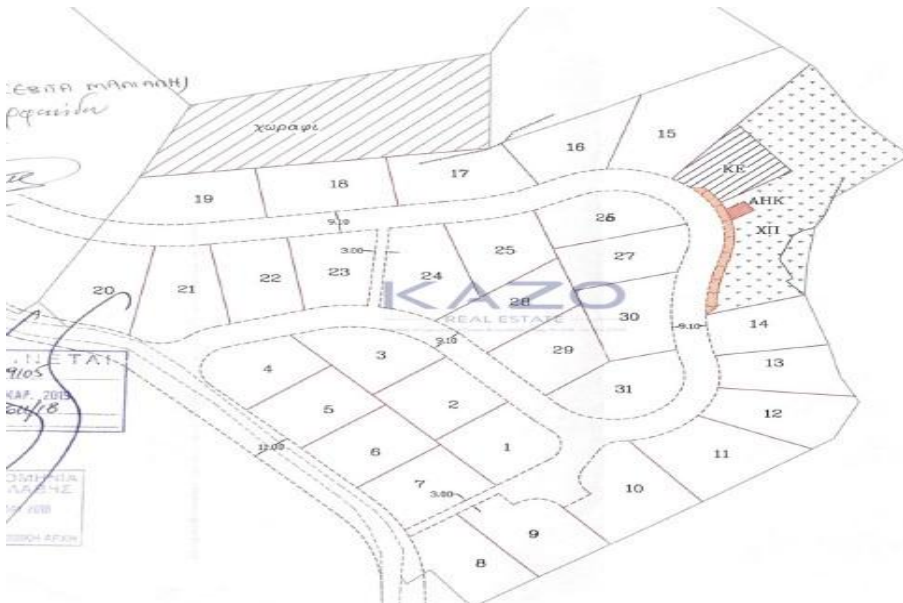

ΚΑΤΑΛΟΓΟΣ ΕΜΒΑΔΩΝ			
ΟΙΚΟΠΕΔΟ	Τ.Μ	ΟΙΚΟΠΕΔΟ	Τ.Μ
1	630	17	705
2	630	18	723
3	630	19	746
4	625	20	762
5	625	21	774
6	625	22	655
7	625	23	627
8	650	24	765
9	719	25	643
10	860	26	632
11	830	27	630
12	673	28	698
13	560	29	646
14	564	30	711
15	1306	31	702
16	655		
Ε_ΧΩΡΑΦΙ= 2857τ.μ			
Ε_ΧΠ= 2323τ.μ			
Ε_ΧΣ= 138τ.μ			
Ε_ΚΕ= 492τ.μ			
Ε_ΑΗΚ= 29τ.μ			