

4 Bedroom Apartment for Sale in Germasogeia, Limassol District

Luxury furnished penthouse for sale in Germasogeia, Limassol. This spacious and elegant penthouse is the perfect choice for those who appreciate comfort, luxury and convenient location. The penthouse has four bedrooms and four bathrooms, as well as an additional guest toilet. The thoughtful layout ensures maximum comfort and functionality. There is a covered veranda of 66 m2. There is also a parking space for the penthouse. Exclusive facilities such as a SPA, gym, sauna and indoor swimming pool are available to the residents of the penthouse. The complex also has an outdoor swimming pool and parking for residents. This is an ideal place for those who lead an active lifestyle and appreciate ...

Property Info

Covered Area	237
Furnishing	Furnished
Energy Efficiency	A
Air Conditioning	All rooms, Yes

Plot / Area Info

Parking **Covered, Yes**

Additional info

Reference Number	187131
Property type	Apartment
Condition	Brand New
Bathrooms	4

Amenities

Location

Location: Germasogeia Region: **Limassol**

Price: €5 150 000 + VAT

VAT for this property is **€522,171** or **€978,500**. VAT usually is 19%. If it is your first purchase of property, you can have VAT reduced to 5% for the first 150sq.m. of the property.

VAT	Excluded	Title transfer fee	None	Common expenses	None
		Price per SQM	€21 730.00/m²		

Representative: DOM Real Estate

Registration number	397	Email	info@dom.com.cy
License number	338/E	Legal name	N/A
Phone: +35796644888			

Price change history

€51 500 000 on Nov 9, 2025
 €5 150 000 on Nov 25, 2025





THE MASTERPLAN

Building area	36,555 m ²
Commercial area	4,230 m ²
Land area	34,000 m ²
Outdoor shopping and dining area	430 m ²
Total shops sea frontage	160 m
Parking space	260 cars

- A. BUILDING A RESIDENCES
- B. BUILDING B RESIDENCES
- C. THE SIGNATURE COLLECTION RESIDENCES
- 1. LE PLAZA DEL MAR
- 2. MAIN ENTRANCE
- 3. SPA / GYM / SAUNA / INDOOR POOL
- 4. RESIDENTS LOUNGE
- 5. OUTDOOR POOL
- 6. LAND FOR FUTURE DEVELOPMENT
- 7. RESIDENTS PARKING
- 8. RESIDENTS UNDERGROUND PARKING
- 9. PUBLIC USE PARKING
- 10. COMMERCIAL USE PARKING
- 11. GUARD HOUSE
- 12. BEACH
- 13. SEA

Penthouse C2101

Building C / Floor 21

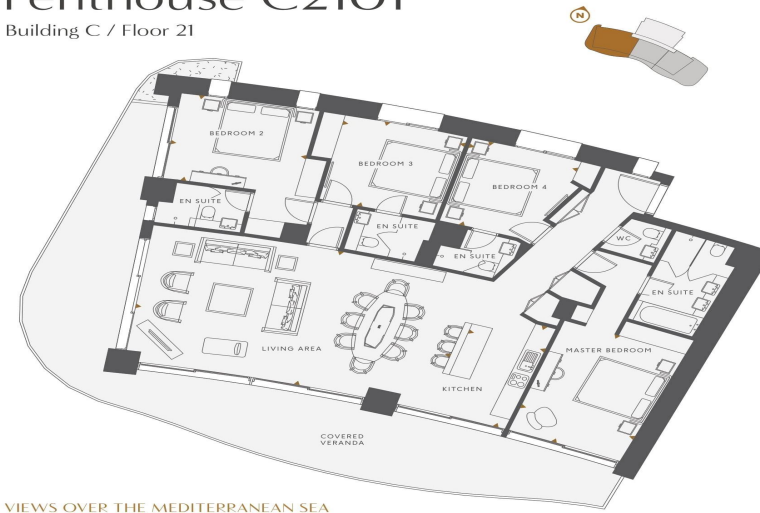

VIEWS OVER THE MEDITERRANEAN SEA