

## 2 Bedroom Apartment for Sale in Germasogeia, Limassol District

Experience refined living in this elegant 2-bedroom apartment, part of an exclusive collection of 17 residences nestled on a green hillside in a quiet, upscale neighbourhood. The building features striking architecture by renowned design studios and stylish interiors that create a truly cosmopolitan atmosphere. 

Bold exterior lines, high-quality materials, and thoughtfully designed outdoor spaces elevate the standard of modern living in Limassol. Privacy, comfort, and convenience are at the heart of this contemporary development, offering not just a home — but a lifestyle.

### Resident Amenities:

- Secure gated entrance
- Covered parking areas
- Crystal-...

### Property Info

|                        |                       |
|------------------------|-----------------------|
| Covered Area           | <b>93</b>             |
| Covered Veranda        | <b>18</b>             |
| Floor Number           | <b>1</b>              |
| Total Number of Floors | <b>4</b>              |
| Energy Efficiency      | <b>A</b>              |
| Air Conditioning       | <b>All rooms, Yes</b> |

### Plot / Area Info

|         |                     |
|---------|---------------------|
| Pool    | <b>Common, Yes</b>  |
| Parking | <b>Covered, Yes</b> |

### Additional info

|                  |                           |
|------------------|---------------------------|
| Reference Number | <b>10431</b>              |
| Property type    | <b>Apartment</b>          |
| Condition        | <b>Under Construction</b> |
| Bathrooms        | <b>2</b>                  |
| View             | <b>Sea view</b>           |

### Amenities

- Parking

### Location

**Location:** Germasogeia  
Coordinates: **34.710264926691 / 33.086400032043**

Region: **Limassol**

## Price: €455 000 + VAT

VAT for this property is **€22,750** or **€86,450**. VAT usually is 19%. If it is your first purchase of property, you can have VAT reduced to 5% for the first 150sq.m. of the property.

|     |                 |                    |                     |                 |             |
|-----|-----------------|--------------------|---------------------|-----------------|-------------|
| VAT | <b>Excluded</b> | Title transfer fee | <b>None</b>         | Common expenses | <b>None</b> |
|     |                 | Price per SQM      | <b>€4 892.00/m²</b> |                 |             |

## Representative: RealDeal Estates

|  |              |            |  |
|--|--------------|------------|--|
| Registration number                      | <b>1311</b>  | Email      | <b>info@realdeal.cy</b>                          |
| License number                           | <b>347/E</b> | Legal name | <b>Esperia Estates (Limassol-Paphos) Limited</b> |
| Phone: <b>+35725255505, +35794001333</b> |              |            |  |

## Price change history

€455 000 on Nov 21, 2025





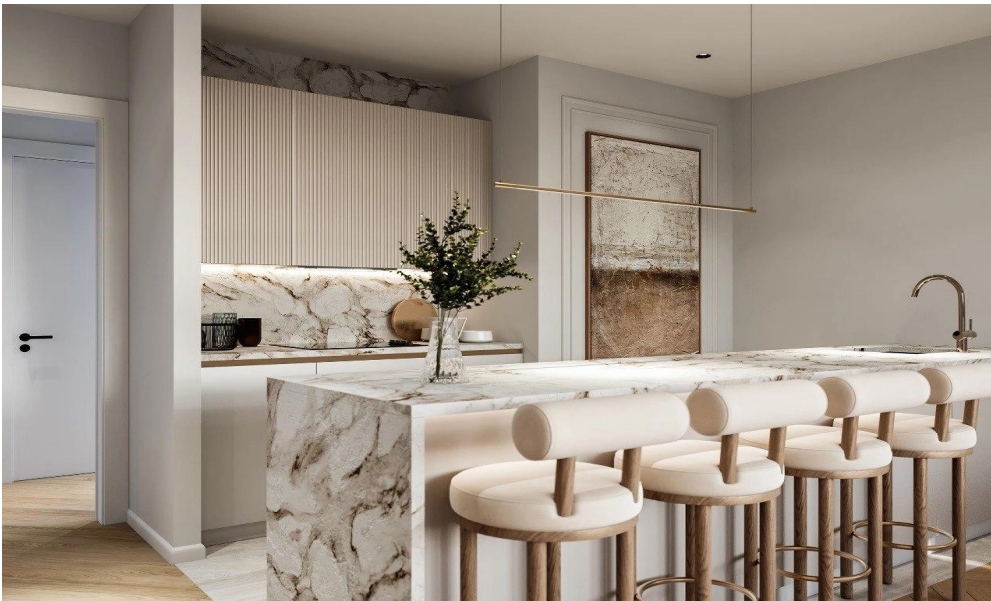





FIRST FLOOR  
Plan

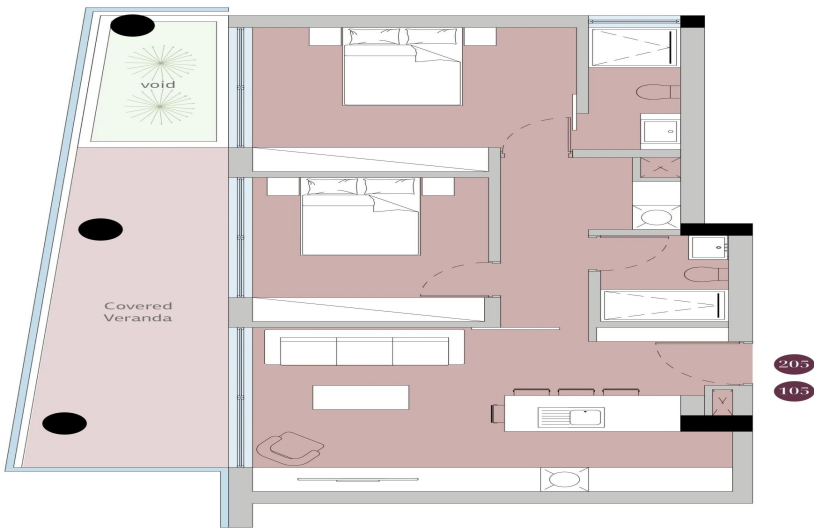

ROOM VIEWS RESIDENT