

## 2 Bedroom Apartment for Sale in Pyla, Larnaca District

Two Bedroom Penthouse Apartment For Sale in Pyla, Larnaca - Title Deeds (New Build Process)  A stunning gated compound project located in the Pyla region, which consists of 6 buildings, each named after a type of pearl, the project includes 119 residential units distinguished by its strategic location near the beach and the British University of Central Lancashire, as well as a wide range of service facilities. The residential units feature elegant interior designs that meet the needs of those seeking a modern lifestyle, with options ranging from 1 - 3 bedrooms. The gated compound of these apartments ensures high levels of security and privacy for its residents and ...

### Property Info

### Plot / Area Info

Covered Area **79**

### Additional info

Reference Number **rea001n2p**  
 Property type **Apartment**  
 Condition **Brand New**  
 Bathrooms **2**

### Amenities

### Location

**Location:** Pyla

Region: **Larnaca**

Coordinates: **35.016667 / 33.683333**

## Price: €278 885 + VAT

VAT for this property is **€13,944** or **€52,988**. VAT usually is 19%. If it is your first purchase of property, you can have VAT reduced to 5% for the first 150sq.m. of the property.

VAT	<b>Excluded</b>	Title transfer fee	<b>None</b>	Common expenses	<b>None</b>
		Price per SQM	<b>€3 530.00/m<sup>2</sup></b>		

## Representative: Emerald Property Consultants

Registration number	<b>845</b>	Email	<b>info@cyprusemerald.com</b>
License number	<b>329/E</b>	Legal name	<b>N/A</b>
Phone: +35723080080			

## Price change history

€278 885 on Feb 21, 2026









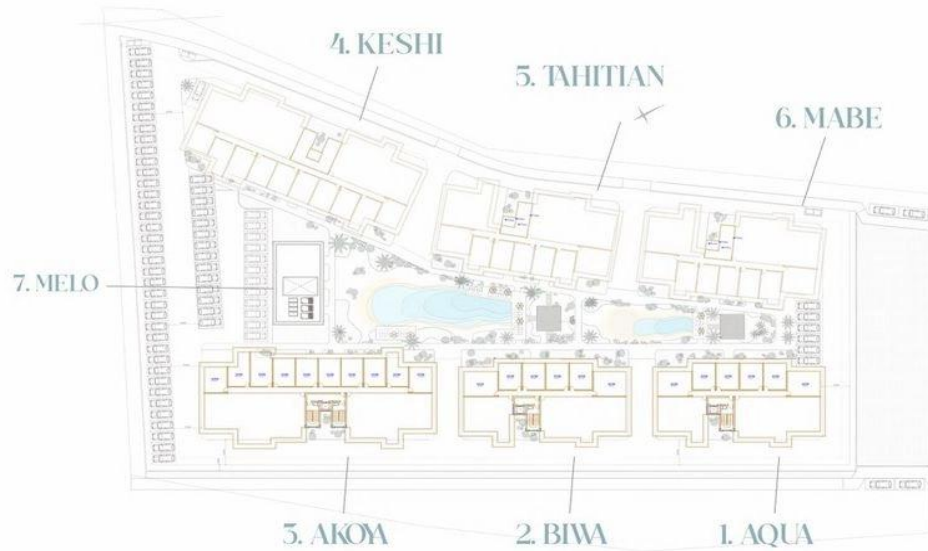

TYPE 1

