

2 Bedroom Apartment for Sale in Oroklini, Larnaca District

Two Bedroom Apartment For Sale in Oroklini, Larnaca – Title Deeds (New Build Process) Set on the same peaceful hilltop in Oroklini, this boutique development offers another collection of refined residences designed for presence, calm, and light-filled living. Deep verandas, open layouts, and floor-to-ceiling glass create a seamless connection with nature, while the outdoor pool, lounge areas, and curated amenities maintain the resort-style rhythm that defines the experience. With panoramic views stretching toward the sea and the city. With only 9 residences, the project remains intentionally low in density, preserving privacy, calm, and a sense of openness. - ...

Property Info

Plot / Area Info

Covered Area **83**

Additional info

Reference Number **khx017n2**
 Property type **Apartment**
 Condition **Brand New**
 Bathrooms **2**

Amenities

Location

Location: Oroklini Region: **Larnaca**
 Coordinates: **34.983 / 33.65**

Price: €230 000 + VAT

VAT for this property is **€11,500** or **€43,700**. VAT usually is 19%. If it is your first purchase of property, you can have VAT reduced to 5% for the first 150sq.m. of the property.

VAT	Excluded	Title transfer fee	None	Common expenses	None
		Price per SQM	€2 771.00/m²		

Representative: Emerald Property Consultants

Registration number	845	Email	info@cyprusemerald.com
License number	329/E	Legal name	N/A
Phone: +35723080080			

Price change history

€230 000 on Apr 9, 2026





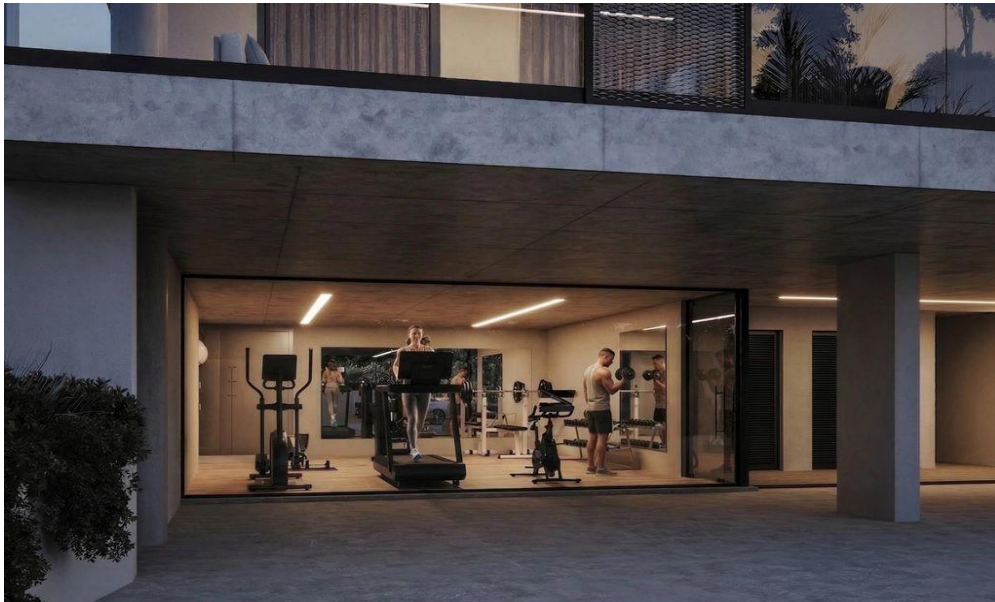





FLOOR PLANS

GROUND FLOOR



FIRST FLOOR



Apartment 101
 100m² covered living area
 28.3m² veranda area
 203m² yard
 6m² storage room
 3 bedrooms
 2 bathrooms (1 en-suite)
 1 parking

Apartment 102
 83m² covered living area
 51.5m² veranda area
 4.5m² storage room
 2 bedrooms
 2 bathrooms (1 en-suite)
 1 parking

Apartment 103
 84m² covered living area
 30.5m² veranda area
 4.5m² storage room
 2 bedrooms
 2 bathrooms (1 en-suite)
 1 parking

SECOND FLOOR



Apartment 201
 100m² covered living area
 24m² veranda area
 8.5m² storage room
 3 bedrooms
 2 bathrooms (1 en-suite)
 1 parking

Apartment 202
 83m² covered living area
 28.5m² veranda area
 3.5m² storage room
 2 bedrooms
 2 bathrooms (1 en-suite)
 1 parking

Apartment 203
 84m² covered living area
 26.5m² veranda area
 3.5m² storage room
 2 bedrooms
 2 bathrooms (1 en-suite)
 1 parking