



## Price: €260 000 + VAT

VAT for this property is **€13,000** or **€49,400**. VAT usually is 19%. If it is your first purchase of property, you can have VAT reduced to 5% for the first 150sq.m. of the property.

VAT	<b>Excluded</b>	Title transfer fee	<b>None</b>	Common expenses	<b>None</b>
		Price per SQM	<b>€2 097.00/m<sup>2</sup></b>		

## Representative: RealDeal Estates

Registration number	<b>1311</b>	Email	<b>info@realdeal.cy</b>
License number	<b>347/E</b>	Legal name	<b>Esperia Estates (Limassol-Paphos) Limited</b>
Phone: <b>+35725255505, +35794001333</b>			

## Price change history

€260 000 on Apr 15, 2026

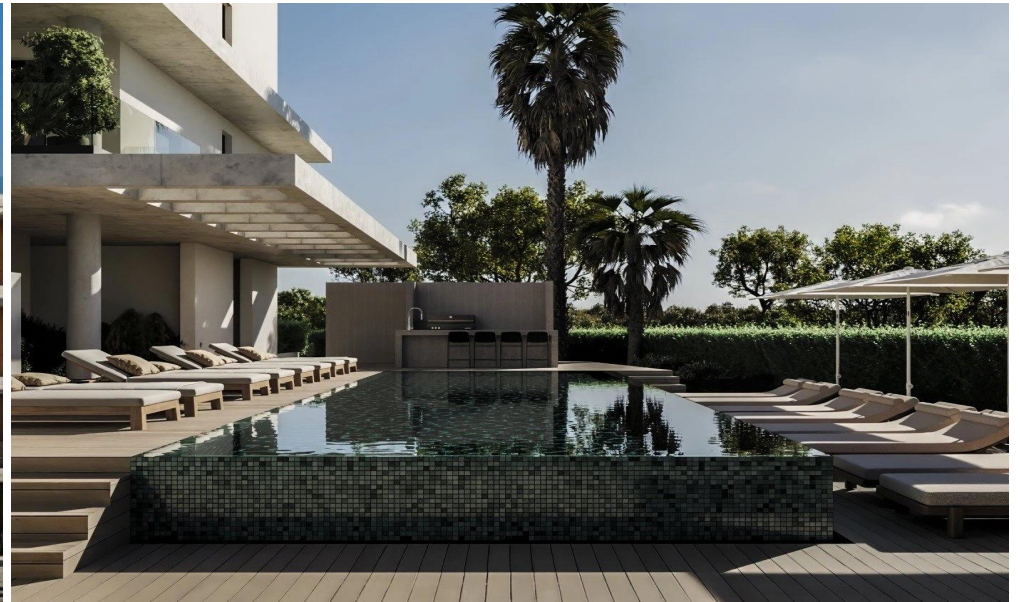







## SECOND FLOOR



**Apartment 201**  
 100m<sup>2</sup> covered living area  
 24m<sup>2</sup> veranda area  
 8.5m<sup>2</sup> storage room  
 3 bedrooms  
 2 bathrooms (1 en-suite)  
 1 parking

**Apartment 202**  
 83m<sup>2</sup> covered living area  
 28.5m<sup>2</sup> veranda area  
 3.5m<sup>2</sup> storage room  
 2 bedrooms  
 2 bathrooms (1 en-suite)  
 1 parking

**Apartment 203**  
 84m<sup>2</sup> covered living area  
 26.5m<sup>2</sup> veranda area  
 3.5m<sup>2</sup> storage room  
 2 bedrooms  
 2 bathrooms (1 en-suite)  
 1 parking

## FLOOR PLANS

## GROUND FLOOR

